



Hoxton

Log Store & Pedestal

Optional Accessory Fitting Guide



PLEASE RETAIN THIS GUIDE FOR FUTURE REFERENCE

EN13240:2011 +A2:2004

BK 761 Rev 01

ISSUE DATE : 13/09/2022



OPTIONAL LOG STORE & PEDESTAL FITTING INSTRUCTIONS

Applicable Part Numbers — LOG-HOX-LOW / LOG-HOX-TALL
PED-HOX-LOW / PED-HOX-TALL



WARNING : Health and Safety

Please consult health and safety guidelines for advice on handling heavy and / or large items.

When lifting the appliance we recommend you always obtain assistance when handling. Extreme Caution is advised, due to the top heavy nature of this appliance.

Appliance Preparation :

Your stove is factory fitted with the integral standard foot assembly, however if it is so desired, this can be removed and an optional log store or pedestal stand can be fitted, so that the appliance height can be raised.

STEP 1:

To remove the factory fitted feet assembly, it is suggested that the canopy assembly & associated hot plate surrounds, be removed to avoid damage. Carefully lower the stove onto its rear, taking care not to damage the rear air box and heat shield cover. We recommend lowering the stove onto the base packing pallet, that it was delivered upon (see upper image).

NOTE : *This step is only necessary, when the direct air cover has been fitted. If fitted, remove direct air cover (highlighted in blue) by following steps 2&3.*

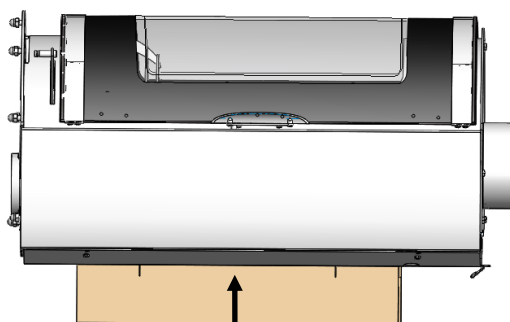

Side View Of
Stove on Packing
Pallet

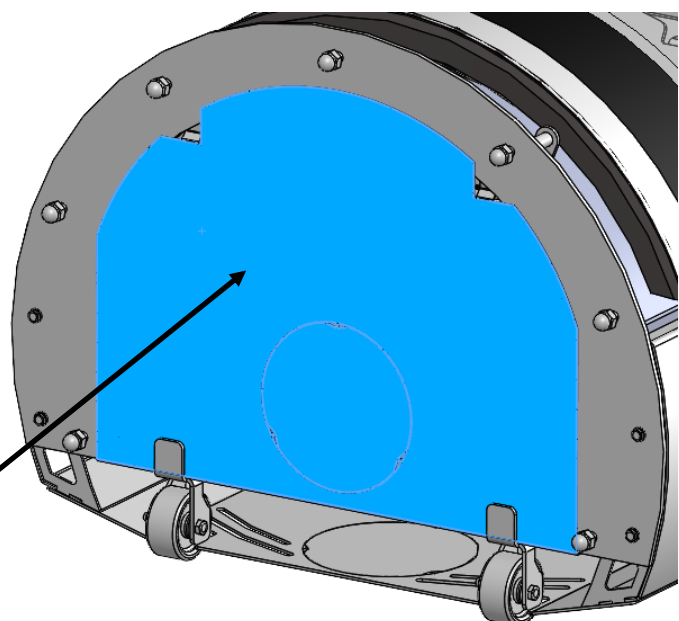

Direct Air Cover

OPTIONAL LOG STORE & PEDESTAL FITTING INSTRUCTIONS

STEP 2

To remove the direct air cover, you will need to remove the wheeled castors and 4x fixings as indicated below. The direct air cover can then simply be with drawn. Retain the castors and fixings in case of later use.

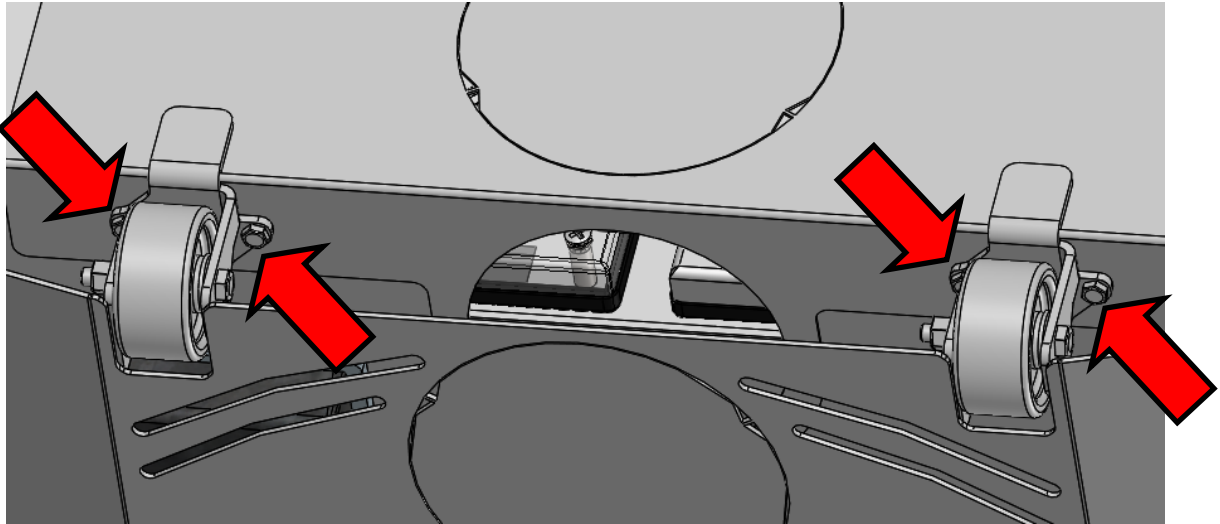

STEP 3:

With the stove safely resting on its back, also remove the 7x dome nuts as indicated below.

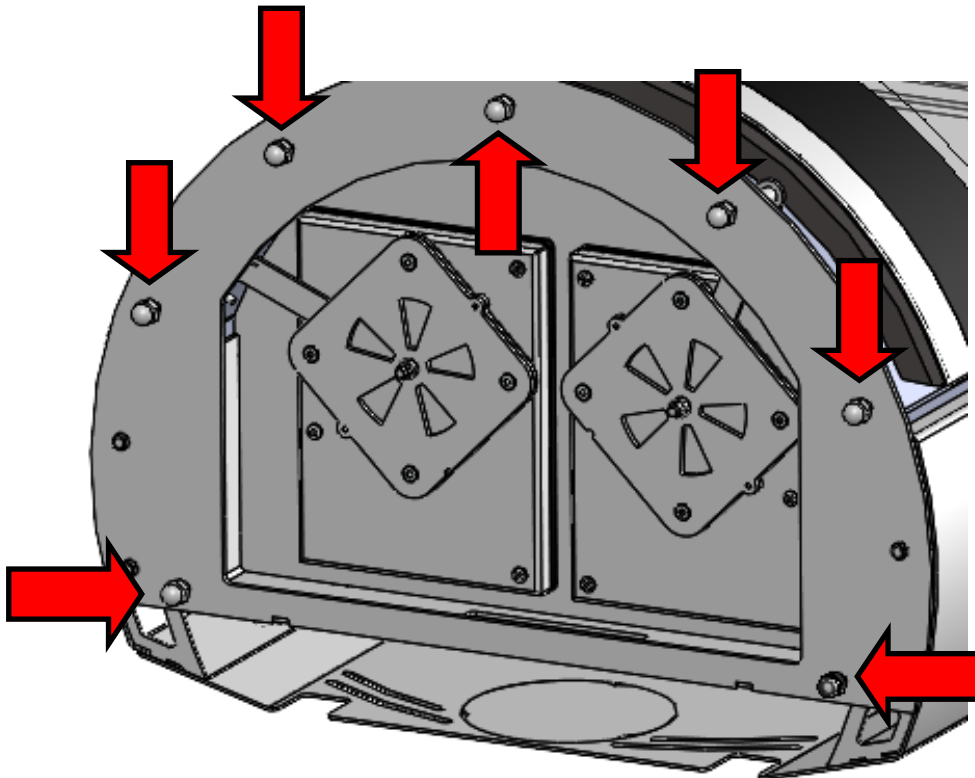

OPTIONAL LOG STORE & PEDESTAL FITTING INSTRUCTIONS

LOG STORE Specific Fitting Instruction :

STEP A: With the appliance resting upon its rear surface (Step 1, page 2), position the log store assembly, against the appliance base, together with aligning the studs to the holes within the top of the log store. Affix the 6 off M8 dome nuts, removed in step 3 (page 3).

NOTE, DO NOT add nut to the stud **CLOSEST** to the hinge, as this will foul the hinge mechanism.

Do not use excessive force when hand tighten these fixings, otherwise damage to the threads and studs, may occur.

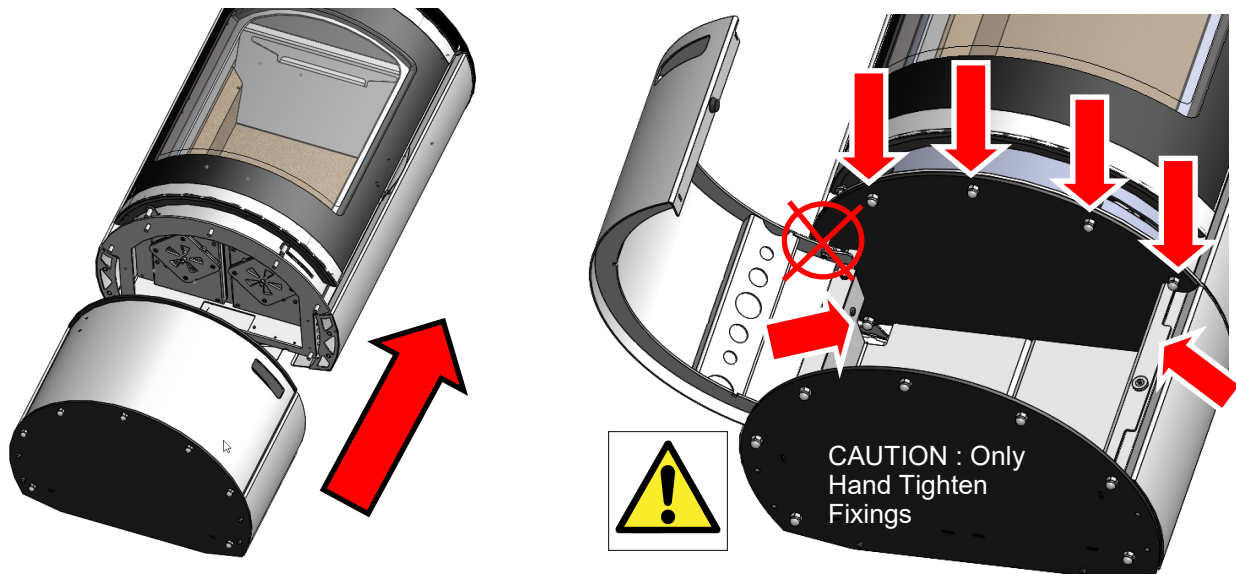

STEP B:

Taking care, return the appliance to the upright position.

Extra caution will be needed, as the centre of gravity will have moved by fitting the new log store accessory.

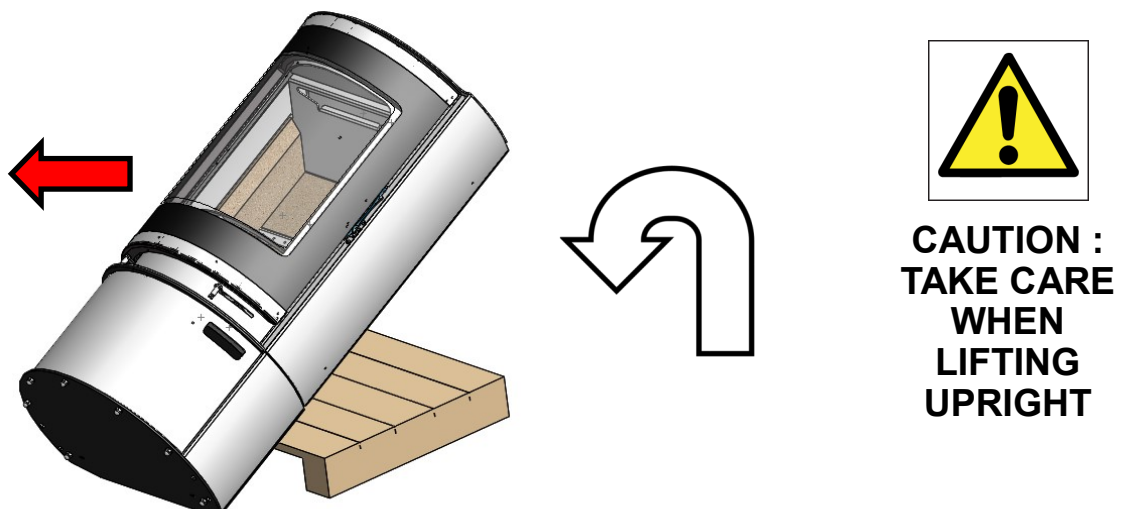

OPTIONAL LOG STORE & PEDESTAL FITTING INSTRUCTIONS

PEDESTAL STAND Specific Fitting Instructions :

To fit the pedestal stand, please follow steps 1 to 3.

STEP C:

With the appliance resting upon its rear surface (Step 1, page 2), position the pedestal stand assembly, against the appliance base, together with aligning the studs to the holes within the top of stand. Supplied with the stand are 7 off black M8 dome nuts. Affix these to the stand, only hand tighten these fixings, otherwise damage to the threads may occur.

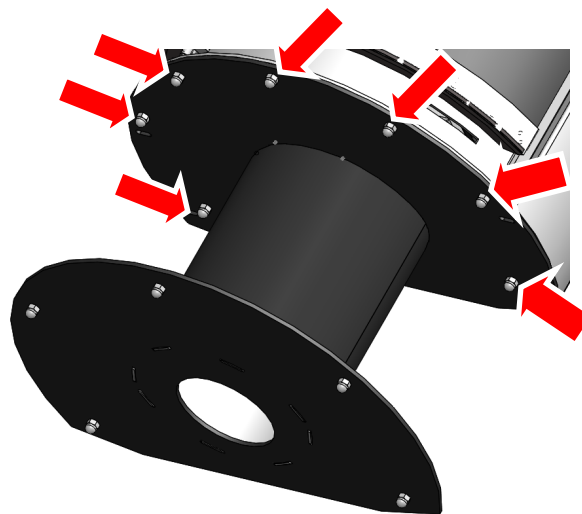

NOTE: Use Black M8 Dome Nuts Supplied

STEP D:

Taking care, return the appliance to the upright position. Extra caution will be needed, as the centre of gravity will have moved by fitting the new pedestal stand accessory.

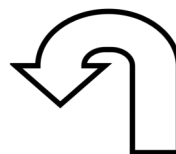
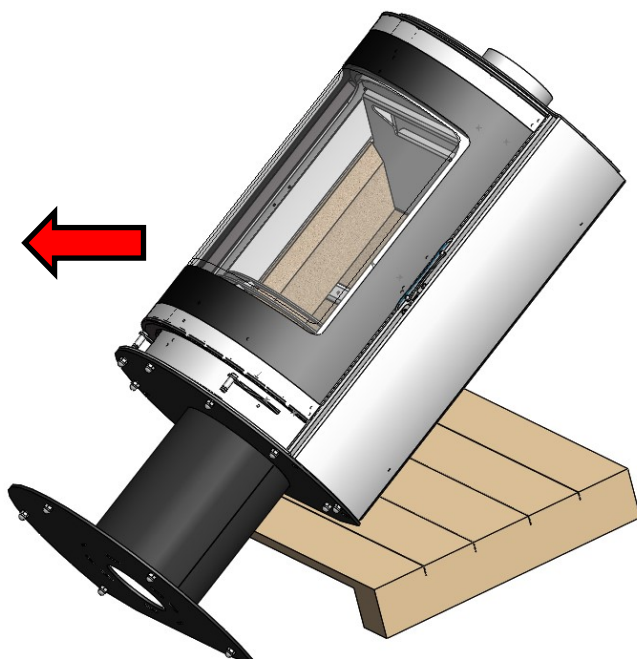

CAUTION :
TAKE CARE
WHEN
LIFTING
UPRIGHT

OPTIONAL LOG STORE & PEDESTAL FITTING INSTRUCTIONS

IMPORTANT INSTALLATION INFORMATION—Stove Fixing Applicable To Both Log Store & Pedestal



WARNING!

It is strongly recommended that the appliance is securely fixed to the floor or hearth, to prevent movement during the opening and closing operation of the fire door and for stability of the assembly.

If excessive force is used when pulling or slamming the fire door, this can result in the appliance moving and damaging the flue connection and surrounding hearth surface.

When installing, secure fixing can be done by using the supplied fixing brackets and fixings.

See below for guidance -

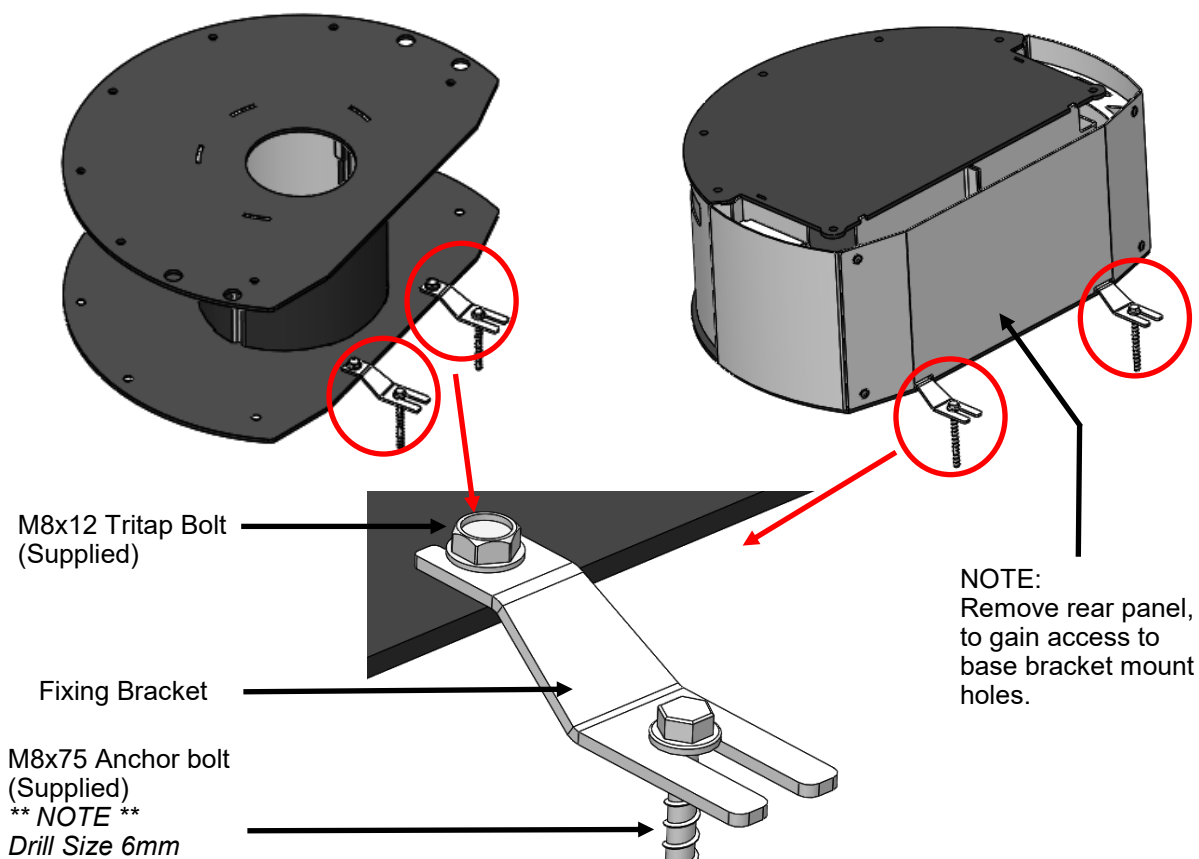

Arada Ltd,
The Fireworks, Weycroft Avenue,
Axminster, Devon,
United Kingdom,
EX13 5HU
Technical Help : +44 (0)1297 632052