



I-Series (S3) Trim Installation

Accessory fitting instructions

PLEASE RETAIN THIS GUIDE FOR FUTURE REFERENCE

EN 13229:2001 +A2:2004

BK 784 Rev 02

ISSUE DATE : 17/02/2025

**UK
CA**

I-Series (S3) Trim Installation

1. Contents Of Kit :

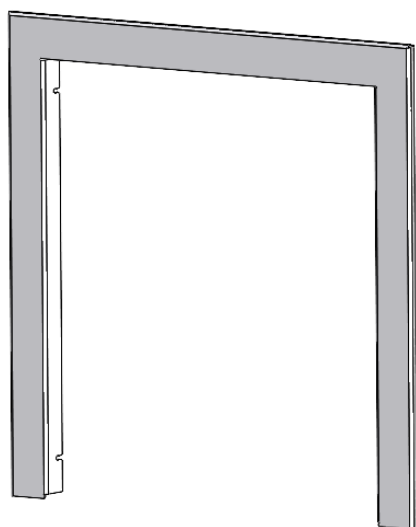

x1 3 Sided Trim (Model Size Specific)

OR

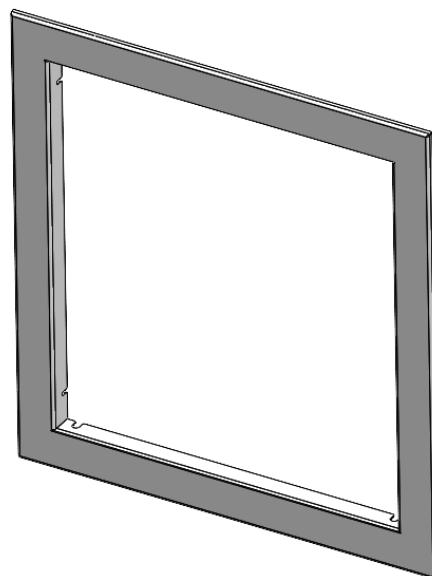

x1 4 Sided Trim (Model Size Specific)

&



x4 Self Tapping Screws

2. Warnings :



NOTE — These instructions are for either type of trim and are applicable to all models of the I-Series S3 cassette stoves.

IMPORTANT — Please ensure the appliance is cold and unlit before commencing fitting this accessory kit.

Observe safe working practices whilst installing or adjusting these components.

Please refer to the main instruction booklet, relevant to your stove, for guidance and operation of the appliance.

Arada Ltd will not be responsible for any consequential or incidental loss or injury however caused.

NOTE — It is recommended removing the door to ease the installation of your trim.

I-Series (S3) Trim Installation

3. Fitting Procedure

The fitting of either the 3 sided trim or 4 sided trim is the same procedure :

Step 1 : On the fitted Cassette stove body, remove the fire door assembly, by opening the door to 90 degrees to the front of the stove. Gently apply an upward force whilst lifting the door assembly and removing the door from its hinges. See Fig. 1.

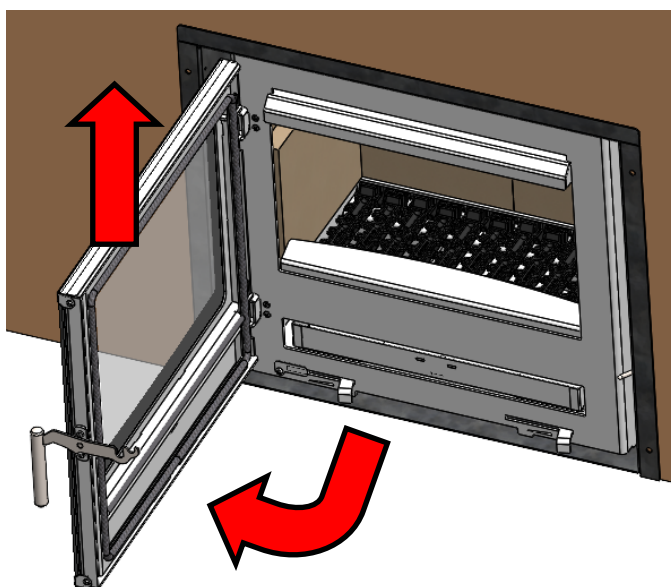

Fig. 1. Removal Of Fire Door Assembly

Step 2 : With the door removed, access to the LH holes (hinge side) are visible in the outer external casing, together with the RH holes, as shown in Fig. 2. Take the 4 no. self tapping screws and fit to each of the holes. (Note — DO NOT FULLY TIGHTEN SCREWS — LEAVE A 4mm GAP (Approx.), as shown in Fig. 3.

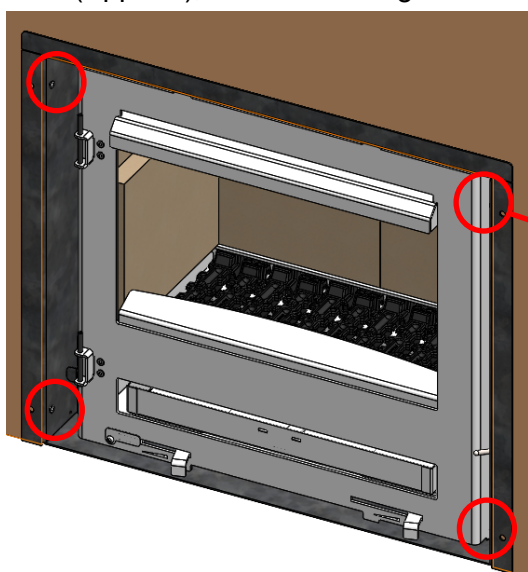

Fig. 2. Hole Locations

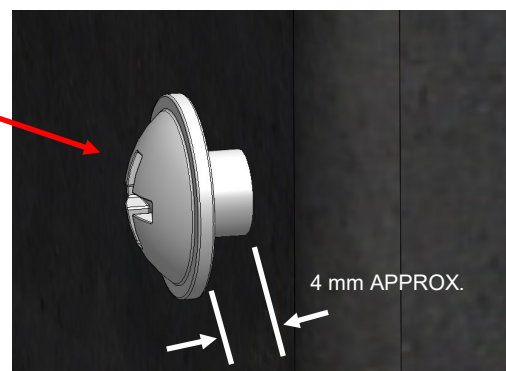
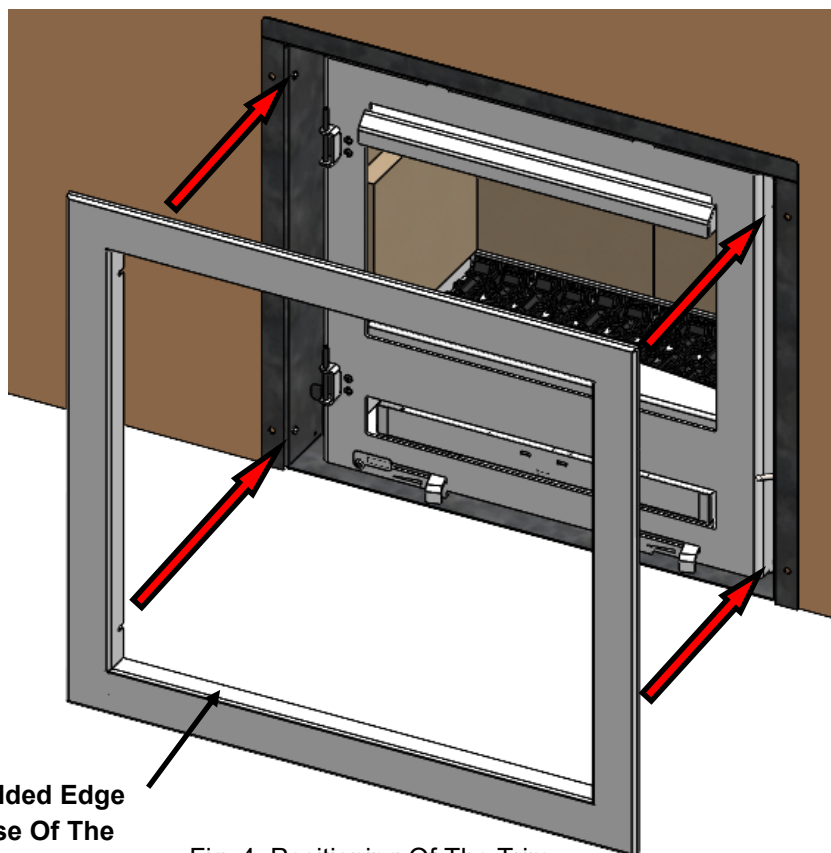

Fig. 3. Detail Of Self Tapping Screw

I-Series (S3) Trim Installation

Step 3 : The chosen surround trim can be positioned onto the self tapping screws within the casing, as shown in Fig. 4.



NOTE : Ensure Folded Edge Is Positioned At Base Of The Appliance Casing.

Fig. 4. Positioning Of The Trim

Step 4 : With the surround trim positioned onto the screws and tight against the surrounding wall or plaster, tighten each screw to retain the trim into position. See Fig. 5.

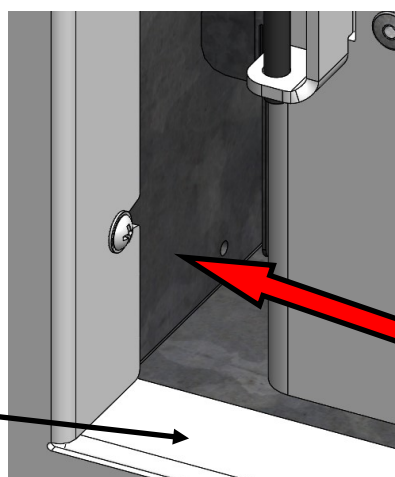

NOTE : View On Bottom LH Corner

Fully Tighten Self Tapping Screws To Retain The Surround Trim.
(All 4x Positions)

Fig. 5. Fixing The Trim

Step 5: Refit the door assembly, by reversing the instructions in step 1 (page 3).

Arada Ltd, The Fireworks, Weycroft Avenue, Axminster, Devon, United Kingdom EX13 5HU



Made In The UK